

SITE PLAN OF PROPOSED THREE STORIED RESIDENTIAL BUILDING AT PRE. NO. 13A, CHETLA ROAD, WARD NO. 82, BOROUGH - (IX), P.S. NEW ALIPORE, KOLKATA - 700027 UNDER K.M.C

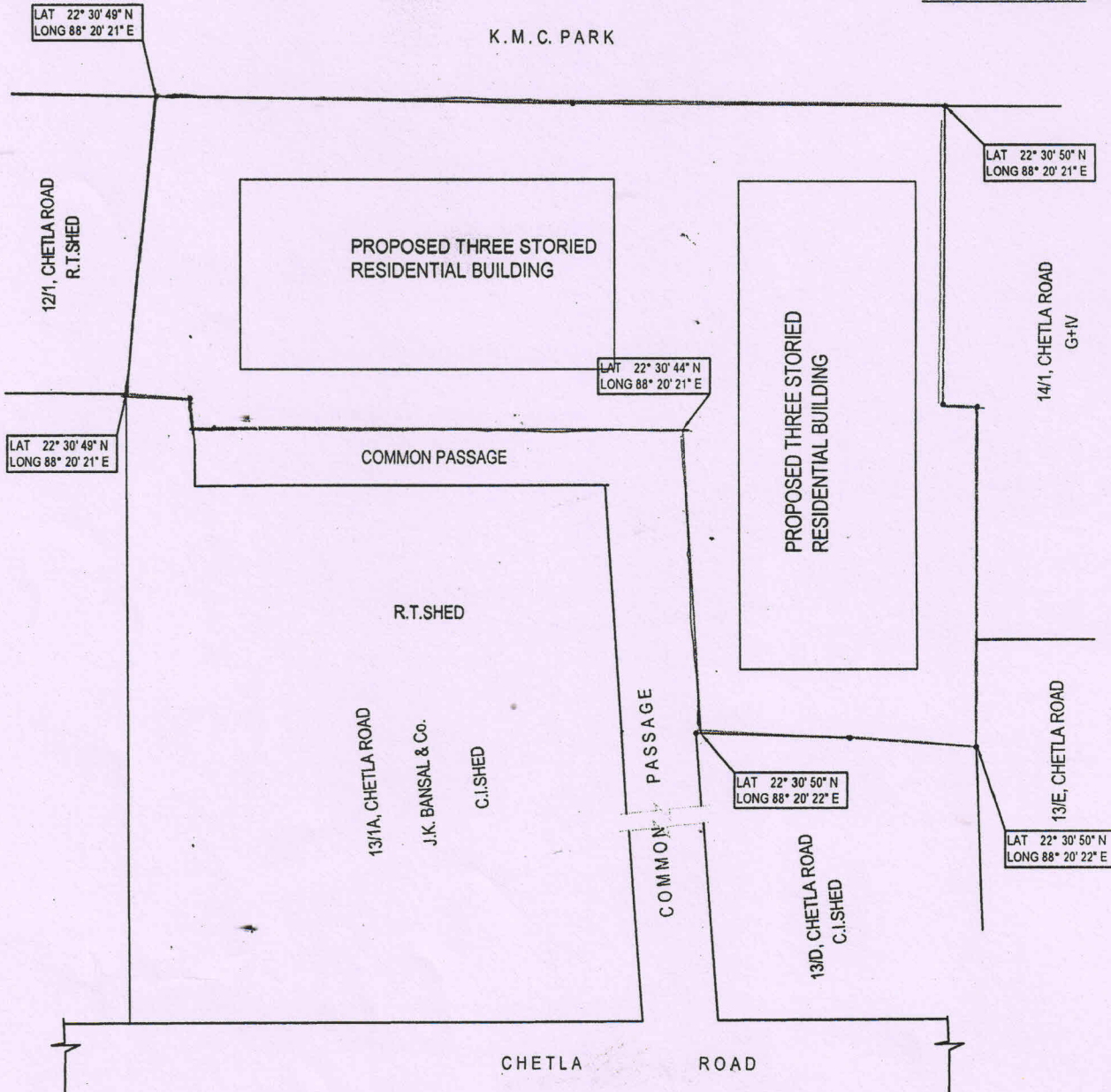

SCALE 1 : 200
ALL DIMENSIONS ARE IN MM.



D'ZIRE
Munish Kumar
Partner

SIGNATURE OF OWNERS

Sumit K. Seal
L.B.S. Class-I, No. 1000
Kolkata Municipal Corporation
(Ph.)-9831084967

SIGNATURE OF L.B.S.